

OVAL HEAD

**MACHINE SCREWS
TAPPING SCREWS
WOOD SCREWS***

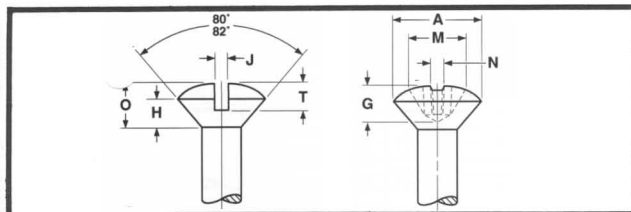

SLOTTED PHILLIPS

Nom. Size	A		H		O		J		T		M		G	N	Phillips Driver Size
	Head Diameter		Height of Head				Width of Slot		Depth of Slot		Dimensions of Recess				
	Max.	Min.	Side Height		Total Height		Width of Slot		Depth of Slot		Diameter		Depth	Width	
	Max.	Min.	Max.	Min.	Max.	Min.	Max.	Min.	Max.	Min.	Max.	Min.	Max.	Min.	
4	.225	.195	.067	.054	.104	.084	.039	.031	.059	.049	.136	.123	.094	.019	1
5*	.252	.220	.075	.062	.116	.095	.043	.035	.067	.055	.158	.145	.085	.028	2
6	.279	.244	.083	.069	.128	.105	.048	.039	.074	.060	.178	.165	.105	.030	2
8	.332	.292	.100	.084	.152	.126	.054	.045	.088	.072	.192	.179	.119	.031	2
9*	.358	.316	.108	.091	.164	.137	.054	.045	.095	.078	.216	.203	.144	.034	2
10	.385	.340	.116	.098	.176	.148	.060	.050	.103	.084	.209	.196	.137	.033	2-3*
12	.438	.389	.132	.112	.200	.169	.067	.056	.117	.096	.270	.257	.152	.038	3
14*	.491	.452	.148	.127	.224	.190	.075	.064	.132	.108	.305	.292	.188	.042	3
1/4	.507	.452	.153	.131	.232	.197	.075	.064	.136	.112	.290	.277	.173	.040	3

PAN HEAD

**MACHINE SCREWS
TAPPING SCREWS
SELF DRILLING SCREWS**

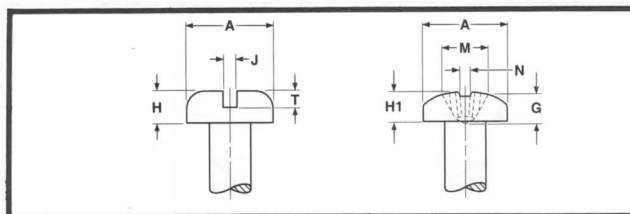

SLOTTED PHILLIPS

Nominal Size	A		H		H1	J		T		M	G	N	Phillips Driver Size		
	Head Diameter		Height of Head				Width of Slot		Depth of Slot		Dimensions of Recess				
	Max.	Min.	Slotted		Recessed		Width of Slot		Depth of Slot		Diameter			Depth	Width
	Max.	Min.	Max.	Min.	Max.	Min.	Max.	Min.	Max.	Min.	Max.	Min.	Max.	Min.	
2	.167	.155	.053	.045	.062	.053	.031	.023	.031	.022	.104	.091	.059	.017	1
3	.193	.180	.060	.051	.071	.062	.035	.027	.036	.026	.112	.099	.068	.019	1
4	.219	.205	.068	.058	.080	.070	.039	.031	.040	.030	.122	.109	.078	.019	1
5	.245	.231	.075	.065	.089	.079	.043	.035	.045	.034	.158	.145	.083	.028	2
6	.270	.256	.082	.072	.097	.087	.048	.039	.050	.037	.166	.153	.091	.028	2
7	.296	.281	.089	.079	.106	.096	.048	.039	.054	.041	.176	.163	.100	.029	2
8	.322	.306	.096	.085	.115	.105	.054	.045	.058	.045	.182	.169	.108	.030	2
10	.373	.357	.110	.099	.133	.122	.060	.050	.068	.053	.199	.186	.124	.031	2
12	.425	.407	.125	.112	.151	.139	.067	.056	.077	.061	.259	.246	.141	.034	3
1/4	.492	.473	.144	.130	.175	.162	.075	.064	.087	.070	.281	.268	.161	.036	3
5/16	.615	.594	.178	.162	.218	.203	.084	.072	.106	.085	.350	.337	.193	.169	4
3/8	.740	.716	.212	.195	.261	.244	.094	.081	.124	.100	.389	.376	.233	.210	4